

How To Add Cameras To DMSS APP

1. DOWNLOADING THE APP

Install the DMSS App to your mobile device. This can be found on the **Google Play Store for Android** users, and on the **Apple App Store for iPhone users**. The icon looks like the image below.



2. ADDING THE CAMERAS TO THE APP

Once you have the app open on your mobile device. You will see the screen below. Simply press on the **+ button** shown in the image. No need to log in or create an account.

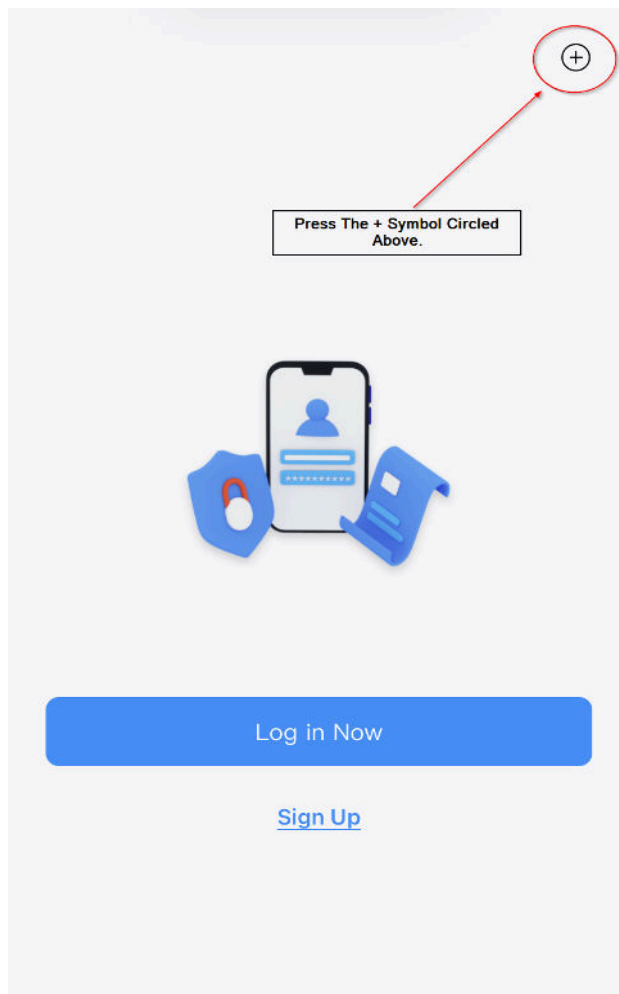

3. SCANNING THE QR CODE (ON THE RECORDER)

Once you have pressed the + sign, select the **Scan QR Code** option. This will open a page asking for you to give access to DMSS to use your camera. Press allow or yes to allow DMSS to use the camera, then simply scan the QR code that is located on the bottom of the recorder (camera box).

SCANNING THE QR CODE (ON THE CONNECTED SCREEN)

Alternatively, you can view the QR code on your connected screen if you have one. To do this, right click with the mouse and select main menu. From there go to Network, and then choose the P2P option at the bottom of the Network menu. You will see 2 QR codes, one will have a Register App option, the other will have a Serial Number. Scan the code with the Serial Number and this will take you to the next step.

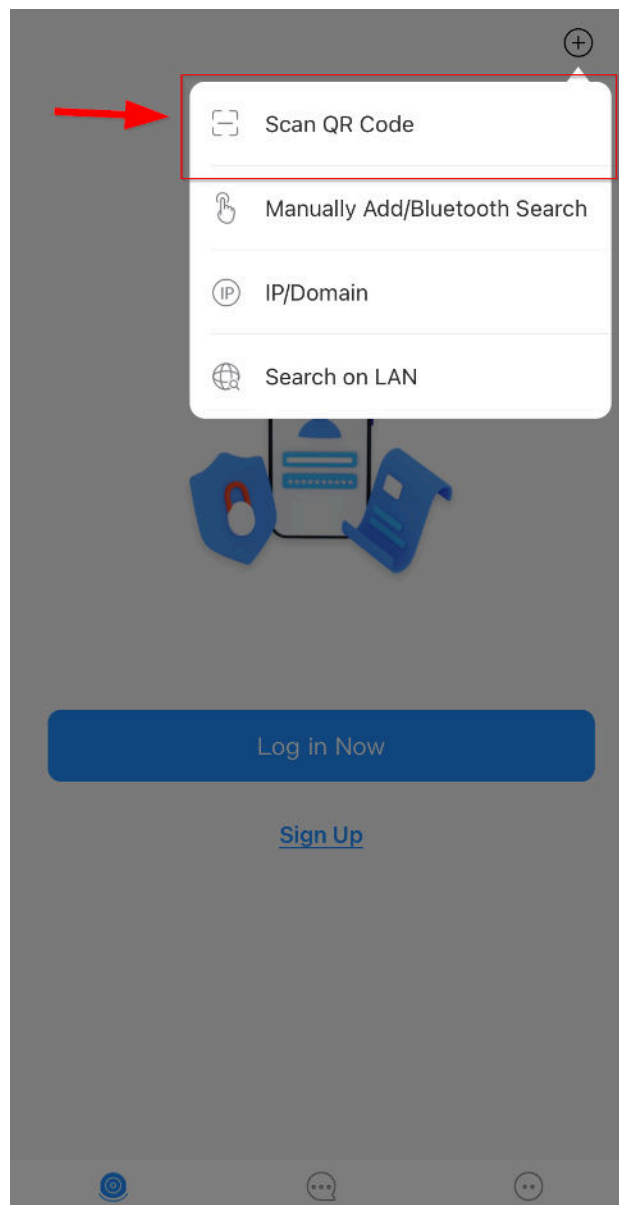

4. MOVING TO THE NEXT STEP

After scanning the QR code, you will arrive at this screen. The serial number will be prefilled and there is no need for a security code for the device. Simply press **NEXT** to continue with the setup.

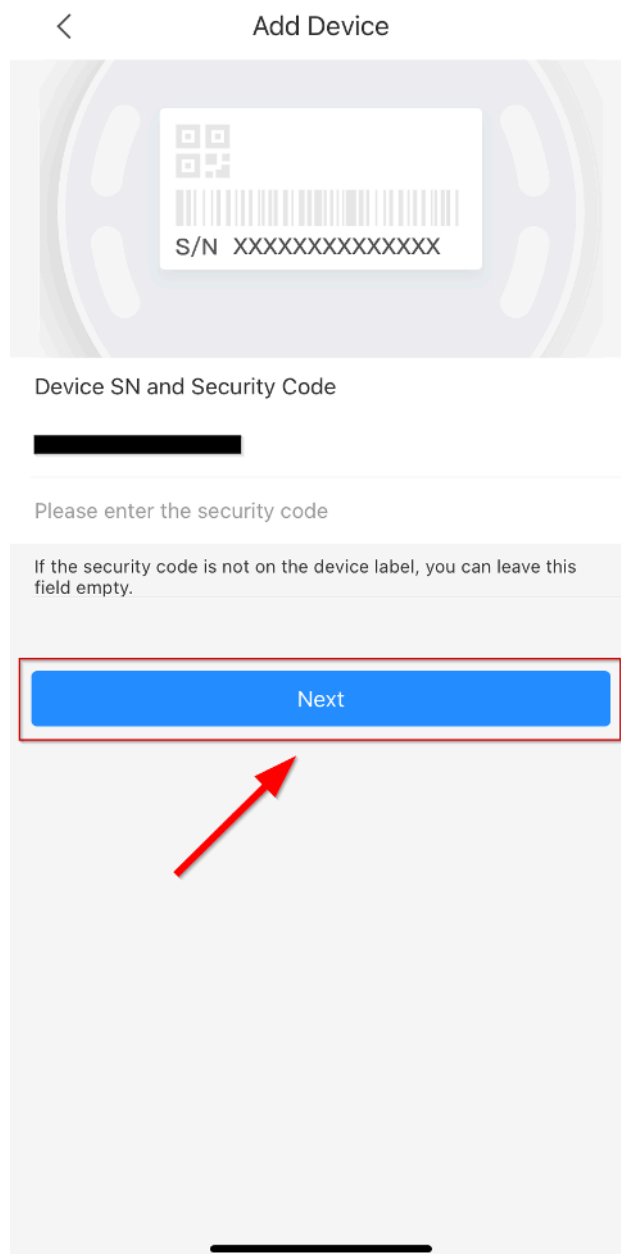

5. SELECTING A DEVICE

The screen below will appear after pressing next. By default, the New IPC menu will be selected. Simply select **NVR/XVR** as shown in the below image, then select **NVR** which is circled below.

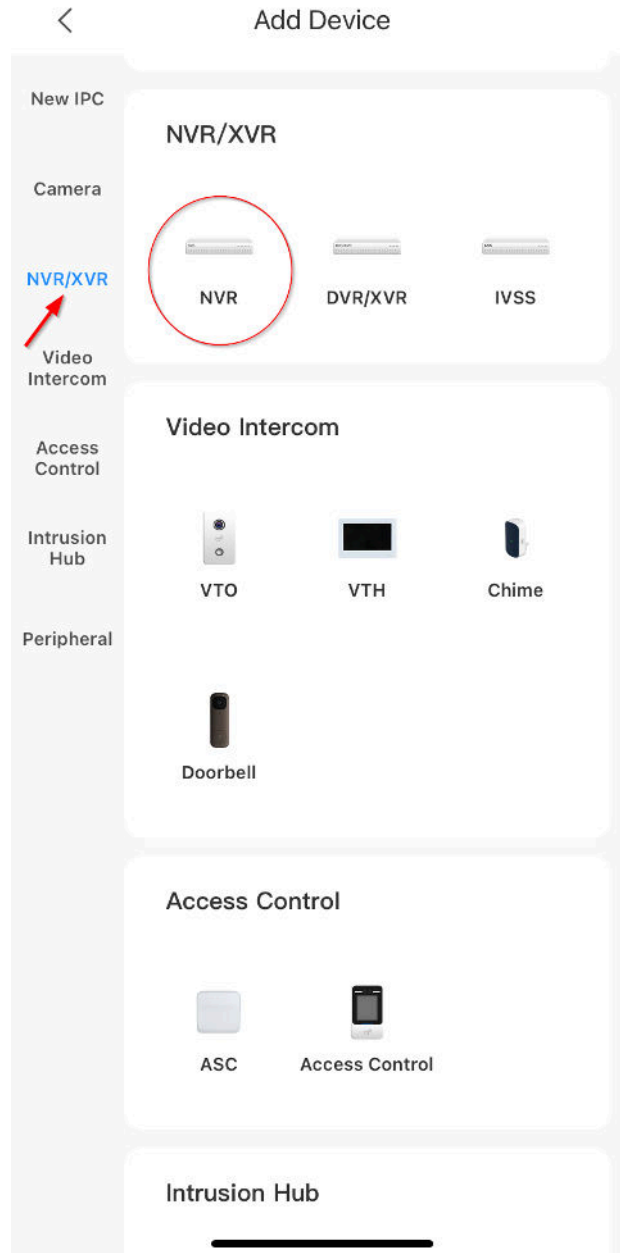

6. SETTING NAME OF CAMERAS AND INPUTTING CREDENTIALS

After choosing the NVR in the above step, you will arrive at the screen shown below. In this section, you will need to type in a name for your cameras, the example shown is using Home as the name. Your user name will be prefilled so you should not need to enter anything in there. Finally, enter in the password for the NVR and press OK at the top right corner of the screen.

(If this installation was done by us, you can contact the office for this information, otherwise contact the person who installed the device and they should be able to give you this information).

The screenshot displays the 'Add Device' configuration interface. At the top, there is a back arrow, the title 'Add Device', and an 'OK' button. Below this is a horizontal separator. The 'Add Mode' is set to 'P2P'. Another separator follows. The 'SN' field contains the value '9B00EFBPAZCCA9A'. The 'Name' field is set to 'Home', with a red circle containing the number '1' and a red arrow pointing to the text. The 'Username' field is set to 'admin'. The 'Device Password' field is currently empty, with a red circle containing the number '2' and a red arrow pointing to the field. To the right of the password field are icons for a close button and a refresh/clear button. At the bottom, there are expand/collapse arrows and a 'Done' button.

7. UPNP (Universal Plug and Play)

Make sure that UPnP is turned on, by default it will be. As long as the toggle is blue it is on. Then press Completed. If the message below appears, disregard as it is not necessary to create an account.

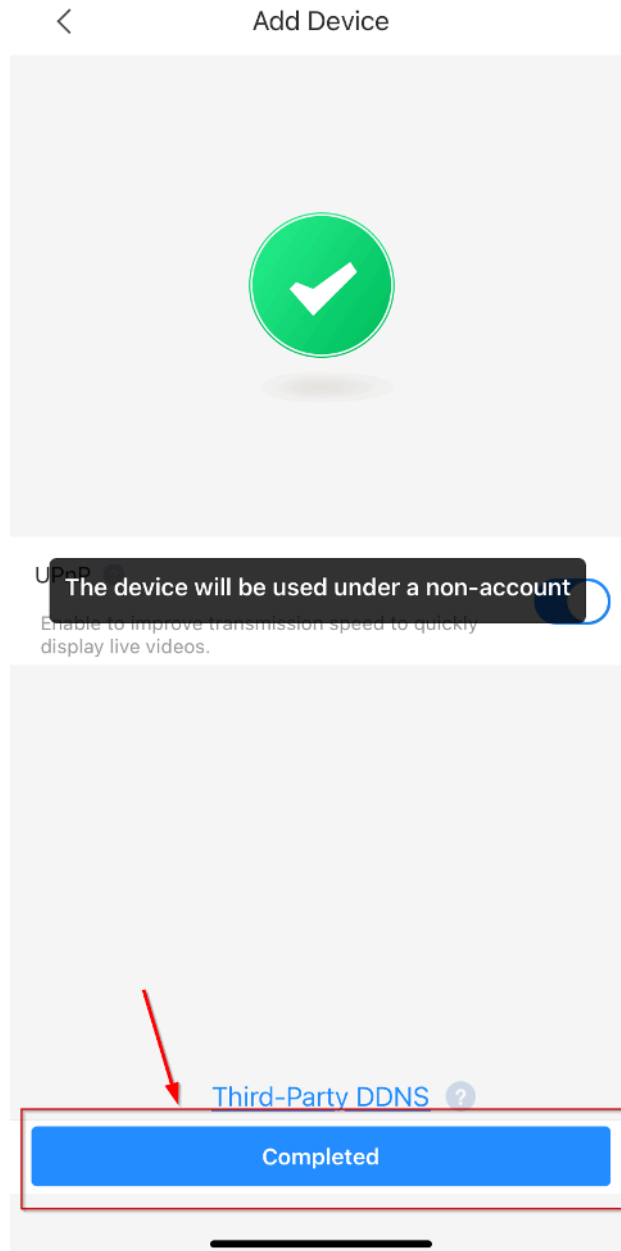

8. COMPLETION

Finally, you will arrive at this screen which will show the cameras in the black boxes below. Congratulations, you have just added the cameras to your mobile device! If you face any difficulties, please contact the office for further assistance or to book a technician if required.

